



Juvenile Barramundi



Boat Electrofishing

FISHERIES & AQUATIC ECOSYSTEMS

CAPABILITY STATEMENT



Fisheries & Aquatic Ecosystem Support

ABOUT CATCHMENT SOLUTIONS

Catchment Solutions is a Queensland based service provider, offering a range of specialised environmental services that combine technical expertise, innovation and collaboration to meet your needs. Working closely with business and government across diverse industries, we provide tailored solutions for strategic environmental and commercial outcomes.

Our core capabilities are:

- **Water Quality Services**
- **Fisheries and Aquatic Ecosystems Specialists**
- **Agriculture Innovation and Support**
- **Ecosystem Rehabilitation and Repair**
- **Environmental Planning and Approvals**

FISHERIES & AQUATIC ECOSYSTEM

Catchment Solutions offers total program delivery of integrated aquatic ecosystem restoration and management. Our staff are recognised as key specialists in their fields of fish passage, water quality, stream rehabilitation and fish community monitoring.

We continue to drive technical and procedural innovation in fish passage and water quality solutions and are committed to integrated, long term and practical natural resource management outcomes.

We work with stakeholders at a project, regional and national scale, servicing both government and the private sector. We offer total program management from detailed design, construction and delivery of fishways and habitat works, through to strategic environmental planning and implementation.

🔵 FISH HABITAT RESTORATION

Including design and deploy structures to provide habitat and refuge for both adult and juvenile coastal and marine fish species

🔵 FISH PASSAGE SOLUTIONS

Including design, construction, implementation and rehabilitation of fishways

🔵 FISH AND AQUATIC HABITAT FIELD SURVEYS

Targeted monitoring of fish and habitats for development of new projects and strategic on-ground environmental management

🔵 FISH BIOLOGY FIELD INVESTIGATIONS

Detailed investigation of specific life history aspects of freshwater and estuarine fish

🔵 AQUATIC ECOLOGY

In-stream fauna assessments and monitoring

🔵 WATER QUALITY MONITORING AND IMPROVEMENT PLANNING

For delivery of on-ground water quality management

🔵 STRATEGIC ENVIRONMENTAL PLANNING AND APPROVALS STEWARDSHIP

Utilising extensive backgrounds in government regulatory processes to ensure compliance



Prototype 'Pyramid' reef module showing surface roughness and juvenile fish habitat

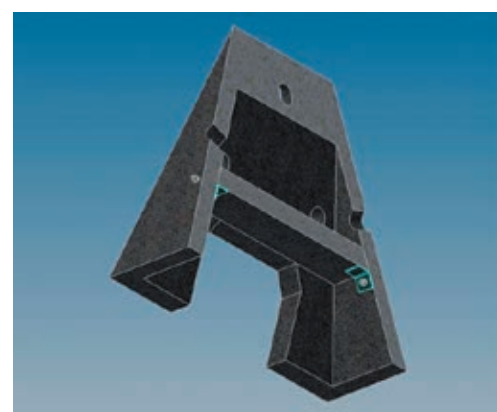

Pyramid Habitat Reef cross-section



Concrete cone fishway, Flinders River, Gulf of Carpentaria



Log fish hotel, Gooseponds, Mackay



• OFFSET PLANNING AND DELIVERY

For individual or strategic offset plans relevant to fish, fish passage, aquatic habitats and water quality

• INNOVATION IN ENVIRONMENTAL SOLUTIONS

Such as fish passage, water quality management and habitat rehabilitation

• ENVIRONMENTAL POLICY AND PROCESSES

Providing plans, procedures and guidelines for pest fish, fish kills, aquatic weed infestation, water quality issues, catchment degradation, instream works

• STAKEHOLDER ENGAGEMENT AND EXTENSION ACTIVITIES

Utilising existing contacts in regional and stakeholder networks to provide knowledge transfers and training



Prototype 'Ledge and Cave' Habitat Reef module

PRODUCTS & SERVICES

- Designed and constructed over 25 successful fishways in Queensland
- Improved the biological productivity of wetlands such as Sandringham Lagoon
- Provided biological expertise and field assessment in fish passage design and monitoring processes for major water infrastructure projects including Paradise, Wyaralong, Nathan and Connors Dams and Tinaroo and Boondooma pipeline screens.
- Undertaken pest fish extermination and removal projects
- Convened three National Technical Fishway Workshops
- Worked on national working groups including the Culvert Initiative, Road Crossings group, Native Fish Strategy
- Authored construction codes for fish passage at culverts and small dams
- Directed government policies including impact assessment, fish passage at barriers, offsets for barriers, fishway design processes and minimum standards
- Undertaken stakeholder engagement for rec fishing and stocking, infrastructure development, pest fish management and habitat rehabilitation



Bremer River Rock Ramp Fishway, South East Queensland



Catchment Solutions Pty Ltd

PHONE (07) 4968 4200
EMAIL info@catchmentsolutions.com.au
WEB www.catchmentsolutions.com.au
ADDRESS Suite 4/85 Gordon Street | Mackay QLD 4740

